



Arlington Heights garden club

February 2017

Growing Together

Carol Elliott, Editor

The 800 Pound Banana in the Room: Recycling Organic Waste

Monday, February 27

Speaker: Mike Nowak

Good gardeners know composting is the key to healthy soils. Mike takes a look, with his own unorthodox style, at the issue of what to do with organics, which account for about one third of our waste stream. Recycling organic materials - specifically food waste - not only reduces the size of our landfills, but if composted correctly, can replenish the nutrients in our soils.

Mike has spent almost 18 years talking about gardening, the environment, and green living on Chicago radio. He now podcasts on his own website and has appeared frequently on local television. He writes an award-winning column for *Chicago Gardening Magazine* and has released a book in 2014.

Greetings from Our President

There is quite a bit of news to share this month! I would like to thank Nancy Asquini-Dean, Renie Norkiewicz, Pete Landwehr, Aggie Prochaska and Jim Spannagel for joining me on January 24th as a Donation Task Force. The task force made recommendations and reviewed suggestions that had been submitted by members on how to disperse some of the proceeds from our successful 2016 Plant Sale & Garden Walk/Unique Boutique. The recommendations, which totaled \$4,918, for an additional scholarship and donations to 12 organizations were approved by the board at the February meeting. Please take a few moments to review page 3 to learn more details about our benefactors.

It is time for us to prepare a slate of officers and committee chairs for the upcoming club year. Our officers and committee chairs serve two year terms from September through August. Please see the article inside this newsletter on volunteering to help us prepare for next year.

Also please see inside this newsletter for news regarding the Garden Walk and other community events.

I look forward to seeing you at our February meeting with Mike Nowak who is a humorous and engaging speaker so please consider bringing a guest!

Kathy Hendricksen, President



BOARD OF DIRECTORS

President
Kathy Hendricksen

Vice President
Donna Soens

Secretary
Bev Krams

Treasurer
Nancy Asquini-Dean

COMMITTEE CHAIRMEN

Artistic
Barb Franks

Civics
Kathy Wolan

Conservation
Jim Spannagel

Horticulture
Pete Landwehr

Membership
Donna Soens

Program
Val Solaski

Publicity
Helen Dawley

Social
Aggie Prochaska

Ways and Means
Adrienne Martz

SPECIAL COMMITTEE CHAIRMEN

Newsletter
Carol Elliott

Scholarship and Website
Mike Dennehey

February Hostesses

A reminder and thank you from Aggie Prochaska, Social Chair, to those bringing treats to our February meeting!

Pat Dennehey

Josephine Perez

Val Solaski



2017-2018 Slate of Officers

It is time for us to be preparing a slate of officers and committee chairs for the upcoming club year. Our nominating committee consists of two board members and three general members. Bev Krams, Adrienne Martz, Renie Norkiewicz and Shelly Plischke have signed up so far. At the February meeting we will be asking for one other general member to sign up to help the committee or please e-mail Kathy Hendricksen at kshend@aol.com if you will help. The committee will get together in March to make some calls to find volunteers to fill any open positions. Please do not be afraid to get more involved in the club to participate in a leadership position. Prior experience is not necessary as we have outlines of responsibilities and the person who held the position before will help transition. It is a great way to get to know members better and have fun!

Latest Garden Walk News

The Garden Walk Planning Committee welcomes new members Renie Norkiewicz and Shelly Plischke who will be assisting with coordinating volunteers. We also are pleased that Sharon Sieg will be assisting with graphical design for Garden Club Publicity. Barb Franks has sent out notices to vendors for the Unique Boutique with some interest already expressed. Pat Dennehey and Kathy Hendricksen are getting ready to send out letters to area businesses for donations to our raffle. We would like to invite members to come to a letter stuffing party including brunch on Saturday, March 4th at 10:00 a.m. at Kathy's house at 1319 N. Dunton Ave.

Garden Club 2017 Donations

Group	Amount	Web Site	Notes
AHGC Additional Scholarship	\$1,500		Committee suggests awarding a second scholarship if there are two qualified candidates
Ar. Hts. Historical Society	\$500	ahmuseum.org	Group that has been a great partner for us to hold meetings and our events and we want to give back as they are a volunteer non-profit
Windsor/Dryden Apartment Community Garden	\$300		Most funding is coming from School District 25, Chamber of Commerce and Rotary but we would like to earmark funds for seeds, planting supplies
Wheeling Township Food Pantry	\$250	www.wheelingtownship.com	Inspired by Mike Relaz suggestion, also think we should try to get volunteer to organize collection-pantry donations at our club meetings
Kew Foundation America	\$100	www.kew.org	Suggestion of Bev Krams-- arm of the Royal Botanic Gardens, Kew in England. Foundation addresses the scientific issues of horticulture at a global level. Through research and networking across the globe they are developing a digital information source called Plants of the World Online Portal.
Lincoln Memorial Garden	\$100	www.lincolnmemorialgarden.org	Garden in Springfield that was started by GCI and has support from many IL garden clubs
Citizens for Conservation	\$100	https://citizensforconservation.org	Barrington group that is expanding to conserve natural areas in McHenry and Cook County
Save our Monarchs	\$100	www.saveourmonarchs.org	Promoting the planting of 1,000,000 milkweed seeds annually
Garfield Farm Museum	\$100	www.garfieldfarm.org	Greater Chicago area farm that teaches about farming and keeping heirloom breeds of animals
Garfield Park Conservatory	\$100	https://garfieldconservatory.org	One of the largest and most stunning conservatories in the nation
Friends of Busse Woods	\$100	www.bussewoods.net	Supports restoration, restocking, and preservation of the natural lands with their floral and fauna. Planning spring field trip for Wildflower Walk
The Tree Fund/Tour Des Trees	\$100	www.treefund.org	Suggestion from Nancy Asquini-Dean and Pat Dennehey. Promotes tree research and education. Signature fundraiser is Tour Des Trees which member Thom Kraak has been in for several years.
Penny Pines	\$68	www.gardenclub.org/projects/penny-pines.aspx	National Garden Club and USDA Forest Service partnership to fund part of the costs of replanting replacement trees in the National Forest for trees damaged by fire or other natural catastrophe. Can designate a particular state if desired
Existing AHGC Scholarship	\$1,500		
Subtotal of Donations	\$3,418		
Total Donations	\$4,918		

Butterfly Weed

2017 Perennial Plant of the Year

A member of the milkweed family has been named "2017 Perennial Plant of the Year" by the Perennial Plant Association. Butterfly weed is a 2' tall, well-behaved perennial that does not take over your flower bed. It likes full sun in well drained to dry soils and is not very picky about conditions or companions. It's leaves support Monarch and Queen butterfly as well as the Tussock moth larvae. Many bees, moths, ants, wasps, beetles and hummingbirds enjoy sips of nectar from the bright orange, red or yellow flowers. Please make a place in your yard for this wonderful plant.

Asclepias tuberosa

2017 Perennial Plant of the Year™



Butterfly Weed
A North American
Native Plant



Hardiness

USDA Zones 4 to 9

Light

Butterfly weed grows best in full sun.

Soil

Grows best in well-drained soils and it is drought tolerant.

Uses

Butterfly weed is a perfect selection for full-sun meadow or prairie gardens as well as formal to semi-formal urban gardens. Flower arrangers find the plants make long-lasting cut flowers.



Images courtesy of Rotary Gardens, Janesville WI



Unique Qualities

Asclepias tuberosa are butterfly magnets. Flowers are a nectar source for many butterflies and leaves are a food source for the monarch butterfly caterpillar.

Maintenance

Butterfly weed is subject to no serious insect or disease problems. Deer usually avoid butterfly weed.

Is it time you took a Gardening Class???

Absolutely!!

Take a look at the educational listings in our newsletter and find something that 'tickles' your fancy! There are numerous offerings anywhere from one hour to eight hours, but now is the time to get out there and take advantage of what the horticulture world has to offer.

This last Saturday we took the time to head down to the Morton Arboretum for the Perennial Plant Symposium. It offered five renowned speakers to entice us to begin thinking about the prospect of SPRING!

The main speaker was Roy Diblik a horticulturalist in our own backyard. Roy owns Northwind Nursery in Burlington, WI, only an hour drive from us. He is responsible for helping to create Lurie Gardens in Chicago. He showed us how to create sweeps of color using our native plantings and reducing our maintenance through design. His concept was to get to know and LOVE 16 plants well and it will simplify your garden life. Check out his book; 'The Know Maintenance Perennial Garden' (AHML 635.932/DIBLIK) There is also an ebook version available in our library!

Want a REALLY low maintenance garden? Try gravel gardening. Head up to Olbrich Botanical Gardens in Madison, WI. Gravel gardens create lasting plant communities, which are great for community facilities to decrease the amount of maintenance and water requirements. These gardens were real show-stoppers.

We learned about Perennials in Cold Climates by M. Heger from Minnesota. He provided us with a list of the Best Performers! Not surprisingly many are natives: Yarrows, Alliums, Milkweed, Goatsbeard, Bee Balms (check out the complete list on our AHGC website).

Irvin Etienne from the Indianapolis Museum of Art entertained us with his own garden photos, highlighting the use of tubers, hosta's, canna's, grasses and caladium to color coordinate in your yard to dazzle your neighbors. We were not sure we were going to make use of the Barbie Dolls riding pink flamingos that he keeps in his yard but the "Frog in a Blender" caladium looked great!!

The last speaker, C. Colston Burrell, provided us with solid advice about putting the 'RIGHT PLANT IN THE RIGHT PLACE'. We can all attest to the fact of moving a plant around to a number of locations in our yard until we know it is 'happy.' He encouraged us to do a little research about the needs of the plant and its part in the community of plants in its surrounding environment. He continued the theme of planting native, creating plant diversity, and reducing or eliminating the use of pesticides.

Go ahead! Take advantage of those classes, workshops, seminar's, and submit your funding request to our AHGC scholarship committee! Now is the time to get out and learn from the experts!! Take a class!! Gardenfest registration opens 2/13/17.

Pete Landwehr and Bev Krams
Master Gardeners University of Illinois Extension.

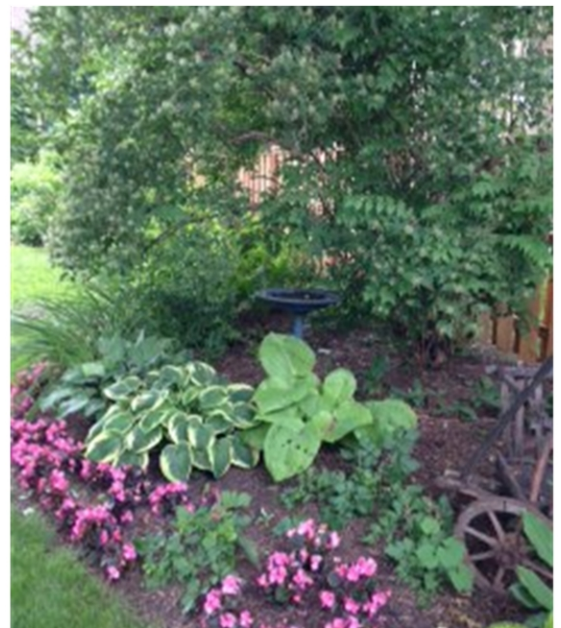

GROWING YOUR GARDEN KNOWLEDGE - February 2017

- Feb. 25 - "Natural Landscape Seminar" sponsored by the WPPC at McHenry County College in Crystal Lake, Ill. \$30 <http://www.thewppc.org/>
- Feb. 27 - "The 800 Pound Banana in the Room: Recycling Organic Waste" by Mike Nowak at our garden club meeting - 7:00 at the Village Hall, 33 S. Arlington Heights Road, Arlington Heights, Ill.
- Mar. 8 - "Spring Care of Perennials" - a presentation by Diana Stoll - at the Garden Club of Mount Prospect - at Friendship Park Conservatory in Des Plaines, Ill. Contact Helen Konieczka at 847-368-9343 for information.
- Mar. 9 - "Growing Dahlias" - Ray and Karen Holich have been growing dahlias since 2001, and propagate over 300 each year. They will explain the process; types, dividing, starting tubers, cuttings, rooting cuttings, and planting. And what to expect the first 45 days, as they grow and need to be disbudded. - at the Des Plaines Garden Club meeting at Frisbie Senior Center in Des Plaines.
- Mar 11 - "Native Shrubs as Habitat and Host Plants" - sponsored by Citizens For Conservation, \$10 for non-members - 9:30 AM at Barrington Village Hall, 200 S. Hough St, Barrington, Ill.
- Mar. 11-12 - "Illinois Orchid Society Show & Sale" - at Chicago Botanic Garden in Glencoe, Ill.
- Mar. 14 - "Plant a Rainbow" - 2017 District IX Annual Meeting and Luncheon - at Concorde Banquets in Kildeer, Il.
- Mar. 18 - "Spring Flower Show" - with lots of free gardening seminars - 9:00 - 3:00 at Knupper's Nursery & Landscaping - Palatine, Ill. <http://knuppernursery.com/event/spring-flower-show-2/>
- Mar. 18-26 - "Chicago's Blooming - the Chicago Flower & Garden Show" - at Navy Pier in Chicago, Ill.
- Mar. 19-20 - "Go Native" - the 90th Annual Garden Clubs of Illinois Convention - at the Chicago Marriott/Naperville - Naperville, Ill.
- Mar. 25-26 - "Northern Illinois Gesneriad Society Show & Sale" - at Chicago Botanic Garden
- Mar. 27 - "Hydrangeas" by Glenn Grosch at our garden club meeting - 7:00 at the Arlington Heights Village Hall, 33 S. Arlington Heights Road, Arlington Heights, Ill.
- Mar. 30 - Post-Orchid Show sale of the excess orchids left over after the end of the show - at Chicago Botanic Garden in Glencoe, Ill.
- Apr 8 - "Personal Land Restoration" - sponsored by Citizens For Conservation, \$10 for non-members - 9:30 AM at Barrington Village Hall, 200 S. Hough St, Barrington, Ill.
- Apr. 8 - "2017 Gardenfest" - 7:30 - 4:00 at McHenry County College - in Crystal Lake, Ill. Keynote speaker is Melinda Myers - \$45 fee includes lunch - <http://www.mchenry.edu/gardenfest/>
- Apr. 22 - Earth Day
- Apr. 24 - "Integrated Pest Management" by Kim Ellson, University of Illinois Extension Educator at our garden club meeting - 7:00 at the Village Hall, 33 S. Arlington Heights Road, Arlington Heights
- Apr. 28 - Arbor Day

Chicago Flower and Garden Club Show

The Chicago Flower and Garden Show will be at Navy Pier, Saturday March 18th-Sunday, March 26th. This year's theme is Chicago's Blooming and features 24 display gardens, seminars and booths. Tickets can be purchased ahead of time online and are between \$15-17. Mariano's is a sponsor and also offers discount coupons. Parking at Navy Pier is \$25. The show web site is www.chicagoflower.com.

If members would be interested in attending Wednesday, March 22nd, you can sign up for a great deal with Salt Creek Park District. Per the below link, \$22 includes transportation and the admission fee with pick up at 9:00 a.m. and drop off at 4:00 p.m. at Twin Lakes in Palatine. Pete and Connie Landwehr signed up for the Salt Creek Park District trip. There are 4 spots left on a 22 passenger bus and Pete is willing to drive to Twin Lakes.

<http://saltcreek.multisportssystem.com/page/show/380607-adult-trips>,

Garden Clubs of Illinois will have a table at the show and members who assist with the table for a "two member two hour shift" will receive a free entry pass to the show. The pass is to be returned to the Show Office before leaving Navy Pier. Upon arrival, volunteers for the GCI booth check in at the Show office on the second floor of Navy Pier to by-pass the normal admission area. The parking fee of \$25 applies and there is no discount. If interested in signing up for a shift or other information, contact Denise Suender, dsuender@yahoo.com or (847)542-1551.

McHenry College Garden Fest Car Pool

We have some members that will be attending the McHenry College Garden Fest on April 8th from 7:30-4:00 p.m. Pete Landwehr will be passing around a sign up for anyone that is interested in carpooling. Registration is now open which is \$45 and includes lunch.

Members could consider applying for the program scholarship to have our club cover half of your cost.

<http://www.mchenry.edu/gardenfest/>

Indoor Farmer's Markets

There are a couple farmer's markets coming up in the Northwest Suburbs. These feature produce, meat, and other food or beauty products. Further information can be found at <https://www.faitinplace.org/our-programs/winter-farmers-markets>

Sunday, February 26th
8:30 a.m. - 1:00 p.m.

First United Methodist Church,
1903 E. Euclid, Arl. Hts.

Sunday March 12th
9:00 a.m. - 1:00 p.m.

Countryside Unitarian Universalist Church,
1025 N. Smith St., Palatine